



Everyone deserves the opportunity
to live their healthiest life.



We are a local non-profit providing medical, dental, behavioral health, and pharmacy services to all ages, regardless of ability to pay.





Sliding Fee Discount Program
accommodates all income levels

“I was an addict and for a few years, I was also homeless. I’ve struggled with epilepsy, headaches, and depression.

Thankfully, fourteen years ago I chose Unity Care NW as my health care home and have taken control of my health and my life.”

*-Bruce
Unity Care NW Patient &
former Board Member*

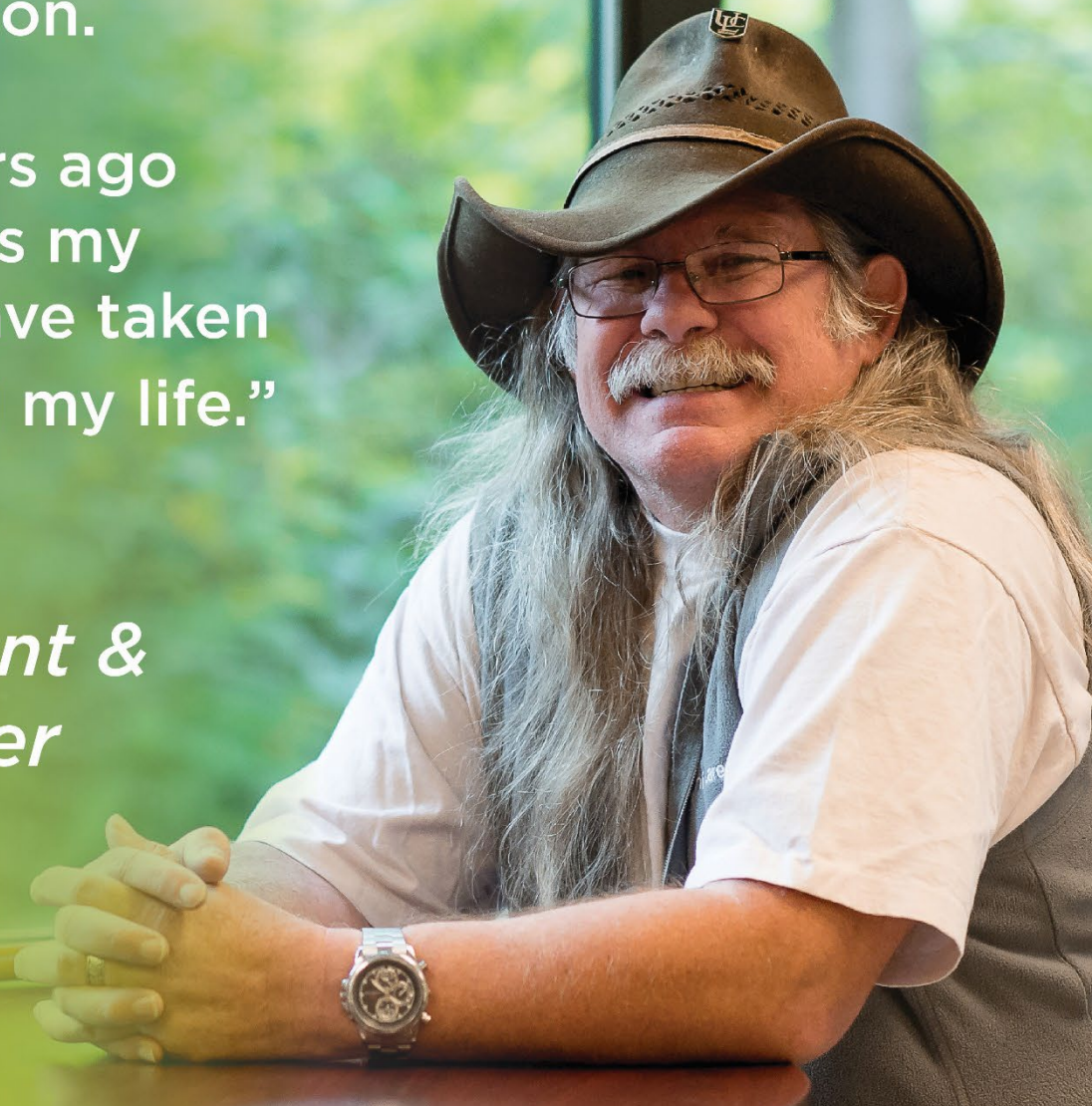



Locations in Bellingham,
Ferndale, and Mobile Dental



Serving 24,750 patients a year
in Whatcom County. *That's 1 in 10!*

Our Patients

60%

On Medicaid

1,600

Uninsured

10%

Unhoused

Patient Federal Poverty Levels

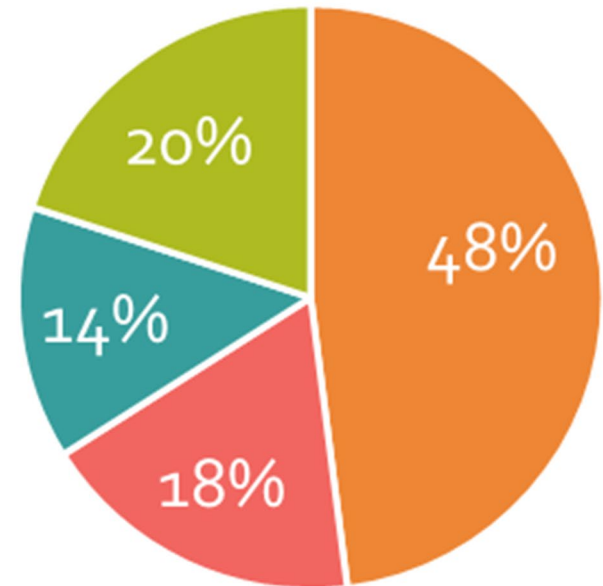

■ 100% and below ■ 101%-150%
■ 151%-200% ■ Over 200%

- We are INNOVATIVE when we:
- Embrace curiosity & continuous learning.
 - Are open to change.
 - Seek new best practices.
 - Learn from the past to make improvements for the future.
 - View challenges as opportunities to find a better way.



7,700 children



2,800 seniors



Our Mobile Dental Van
visits all Whatcom County School Districts
(75 sites!) and serves 1,500 kids a year.



Pharmacy fills 6,500 prescriptions per month
AND provides delivery too!

Unduplicated Patients

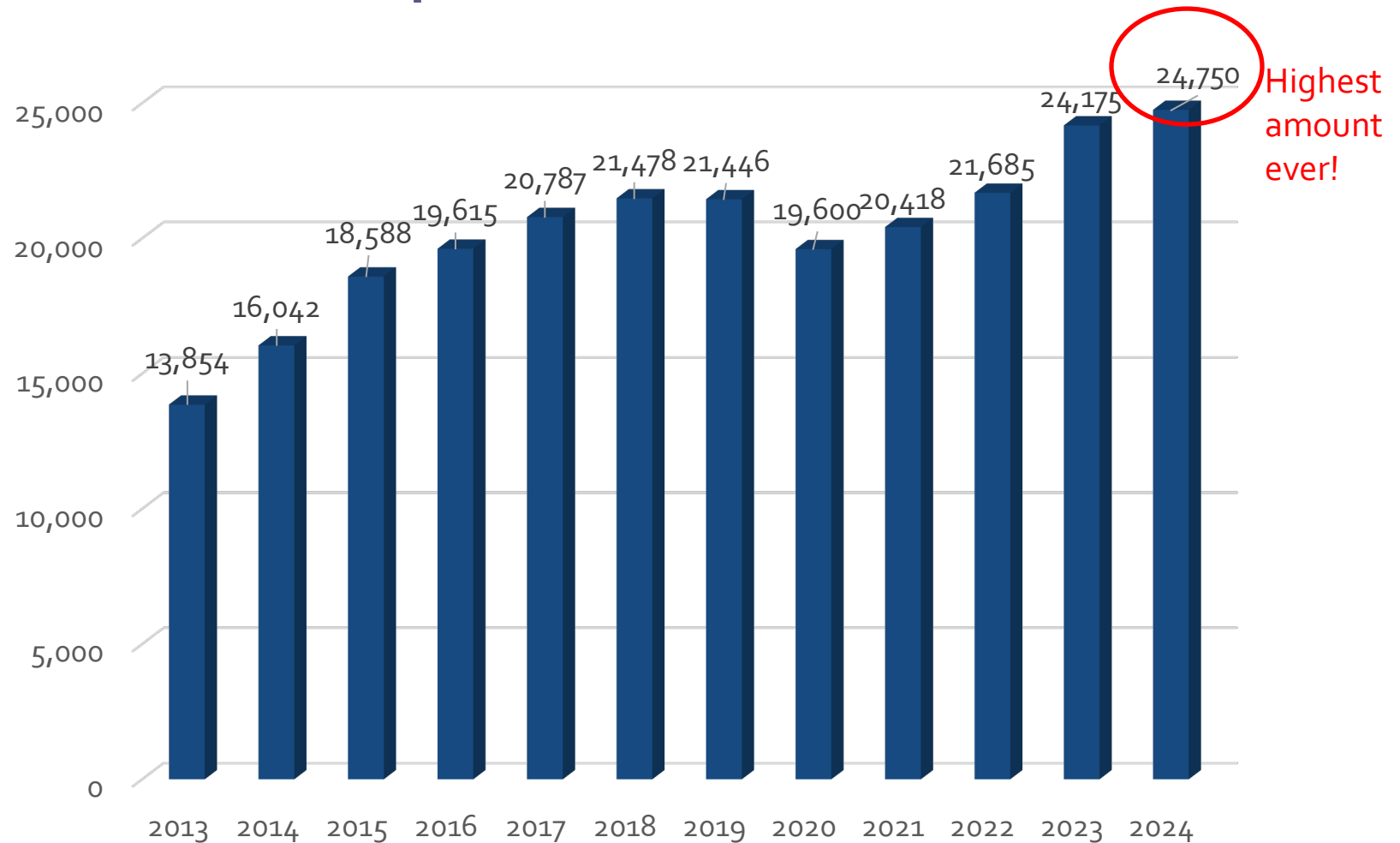



“I’m thankful that my whole family now has a place to go.”

-Julie

Unity Care NW Patient



The Way Station

THE WAY STATION – NOW OPEN

The Way Station Health & Hygiene Center is now open.

Located at **1500 N. State Street**, this facility is offering people experiencing homelessness access to laundry services, restrooms, showers and health care at no cost.



Health & Hygiene Services



Hygiene services: restrooms, shower and laundry facilities, and a hot room to eradicate body bugs found in belongings.



Health care services (Medical, Behavioral Health and Substance Use care) with lab testing, vaccines, and health monitoring.



Case management provides visitors with social and health service resources, plus connections to stable housing opportunities.



Partners + Supporters

- **PeaceHealth** – Medical Respite Care referral and funding partner
- **Opportunity Council** - Medical Respite Care coordinators and Co-located support services
- **Whatcom County Health and Community Services**– Discussing the possibility to co-locate appropriate services like GRACE, EMS, and LEAD
- **Whatcom County** – Property owners and coordinated remodel
- **Northwest Youth Services** – Referral partner
- **Washington State Senator Sharon Shewmake and Rep. Joe Timmons**
- **U. S. Representative Rick Larsen**

THE WAY STATION: HEALTH & HYGIENE CENTER

FLOORPLAN

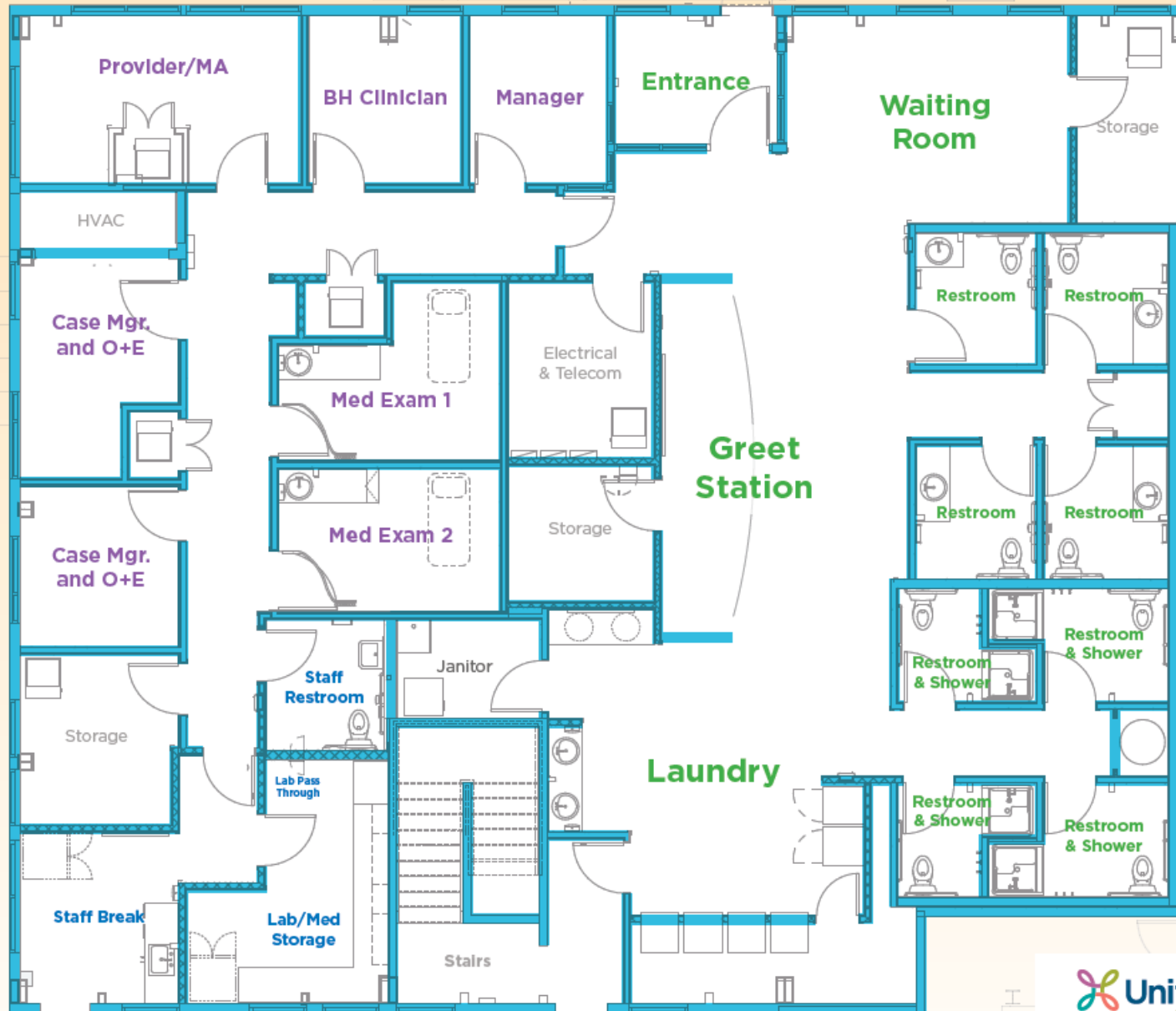



Service Numbers

WAY STATION SERVICES

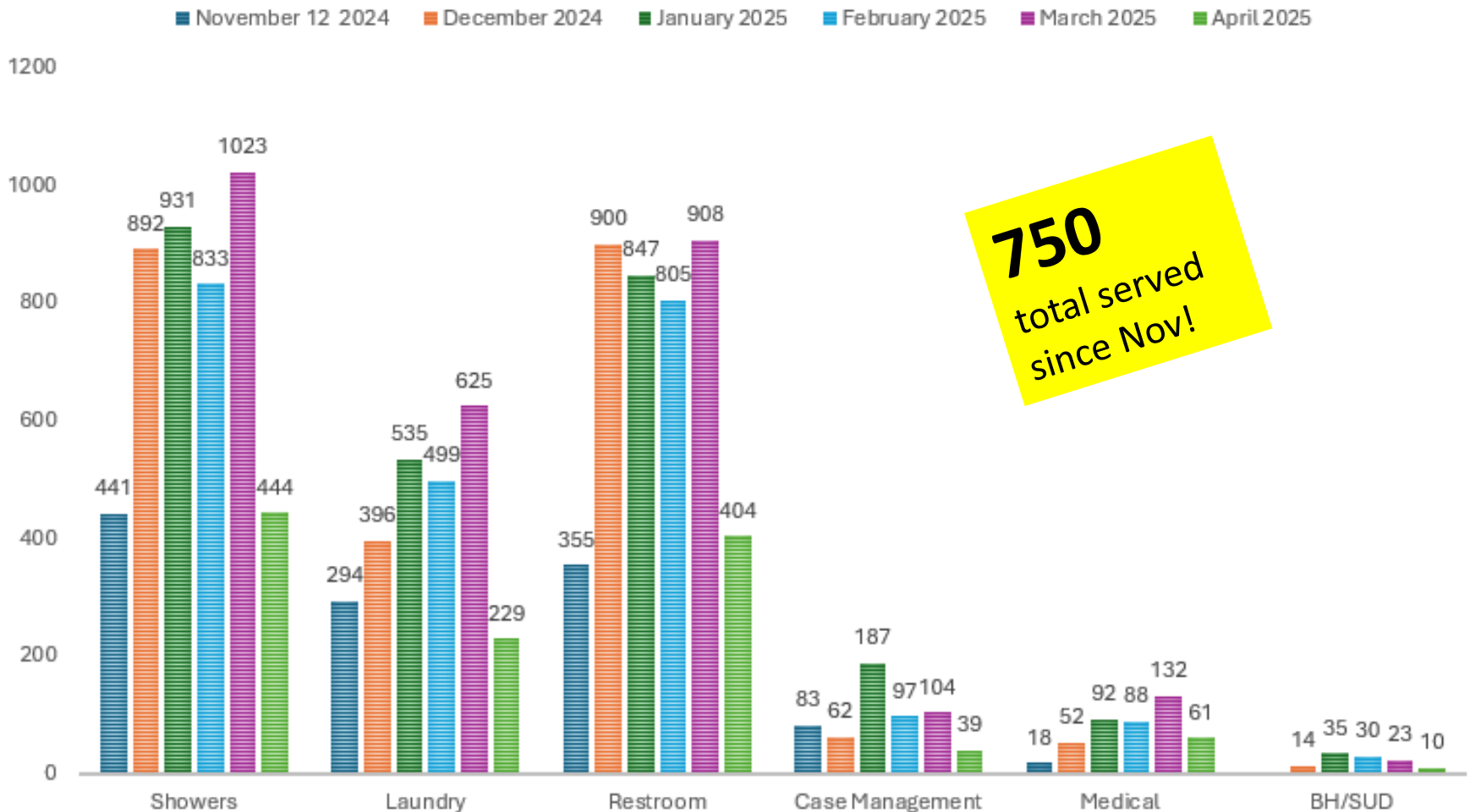

Restricted Funds and The Way Station Budget

\$1.1 million - The Way Station annual operating budget

- **FQHC** - UCNW is a Federally Qualified Health Center with limited and restricted funds
- **Some services** (such as hygiene) are not reimbursable through insurance
- **Majority of funds** for The Way Station hygiene services need to come from outside funding sources

Funding secured and being pursued:

- Individual donors and grants
- Insurance reimbursements when applicable (for medical, behavioral health, and substance use disorder services)
- Federal Funds (restricted to specific expenses):
 - Health Resources and Services Administration (HRSA)
 - Department of Housing and Urban Development (HUD)

\$456,406

*Current unfunded amount needed to
ensure the program's ongoing operational success.*

United Way of Whatcom County Can Help!

\$50,000 will help change lives
and supply the following support:

- Purchase supplies for showers, laundry and bathroom facilities
- Cover costs of Intake Coordinator staff
- Pay for expenses for facility upkeep, maintenance, and repairs to ensure a safe, clean, and operational site.

THE WAY STATION:

HEALTH &
HYGIENE CENTER

Support the journey!



“I haven’t had a hot shower in over a month, thank you for being here!”

-Grateful patron during the first week The Way Station opened



Thank you United Way of
Whatcom county!

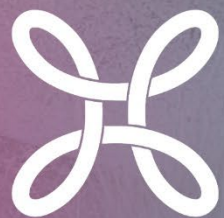

Unity Care NW

Health Care for Everyone